



VINTNER ~ 3,638 TOTAL SQFT

MAIN LEVEL:

1,819 sqft | 3 bed | 2 Bath | 2 or 3 car garage

BASEMENT:

1,819 sqft | possible 2 bed | 1 Bath |

PUEBLO: 719.225.1270 | SPRINGS: 719.426.2270 | MARK@SKYCREEKHOMES.COM | BRIAN@SKYCREEKHOMES.COM

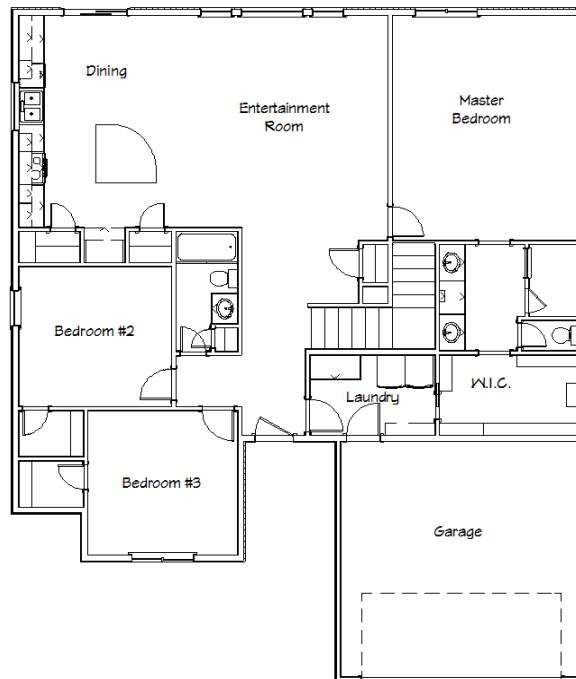
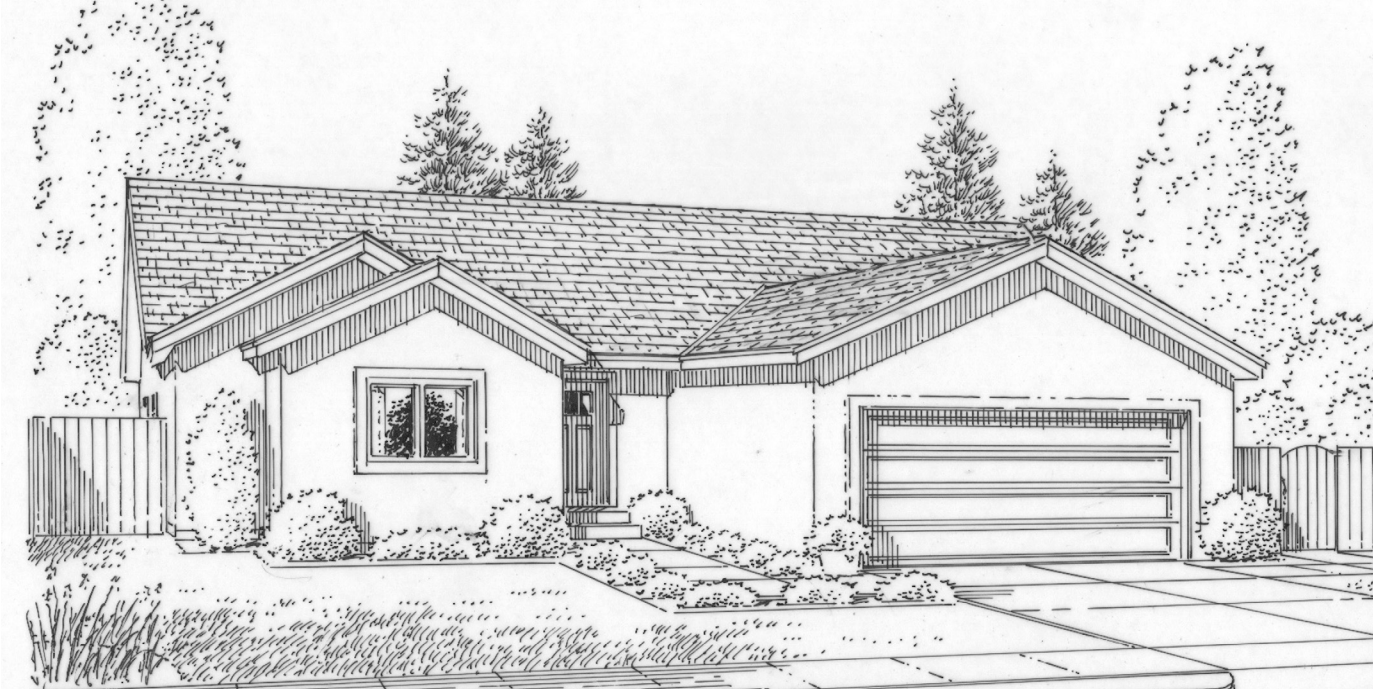

Copyright 2014 Sky Creek Homes, Ltd. These floor plans are for illustrative purposes only and are subject to change without notice or obligation. Elevations and plans may demonstrate optional features and may not represent the lowest price homes in the area. Please contact us for specific information.